

Knez Homes American Legacy

The Katherine Victoria



A Distinctive 1st Floor Master Plan With Style and Space

The Katherine Victoria offers a great design with spacious rooms and distinctive details & features throughout. Custom home quality at a price that will surprise you.

- 3,640 + square feet of Living Area
- Wall of Windows in Vaulted Great Room
- Spacious 1st Floor Master Suite
- First Floor Office/Study
- Huge Open Kitchen with Eating Area
- Four Additional Bedrooms Up
- Three Full, One Half Bath
- Hardwood and Ceramic Floors
- Beautiful Trim Details Throughout
- Maple Cabinetry and Granite Tops
- Green Building Initiative Design
- Energy Star Compliant Construction



Knez American Legacy Series Homes

Knez is building in many of Lake & Geauga Counties' most desirable neighborhoods. We can build on your lot too. For northern Lake County call Carol Nagel at 440-336-3771, for southern Lake and Geauga County call Rick Carrabine at 440-223-1617.

In an effort to constantly improve the quality and value of our homes, B.R. Knez Construction reserves the right to update materials and specifications. 7/1/2010



B.R. Knez Construction, Inc.
8023 Cille Road - Suite 250
Concord Township, OH 44077
(440) 710-0711
Fax: 639-6485

Katherine Victoria
1st Floor Plan

The XYZ Residence
Development Name
Anytown, Ohio

REVISION
DATE
DRAWN
DATE
C SIZE
ARCH
SHEET
2

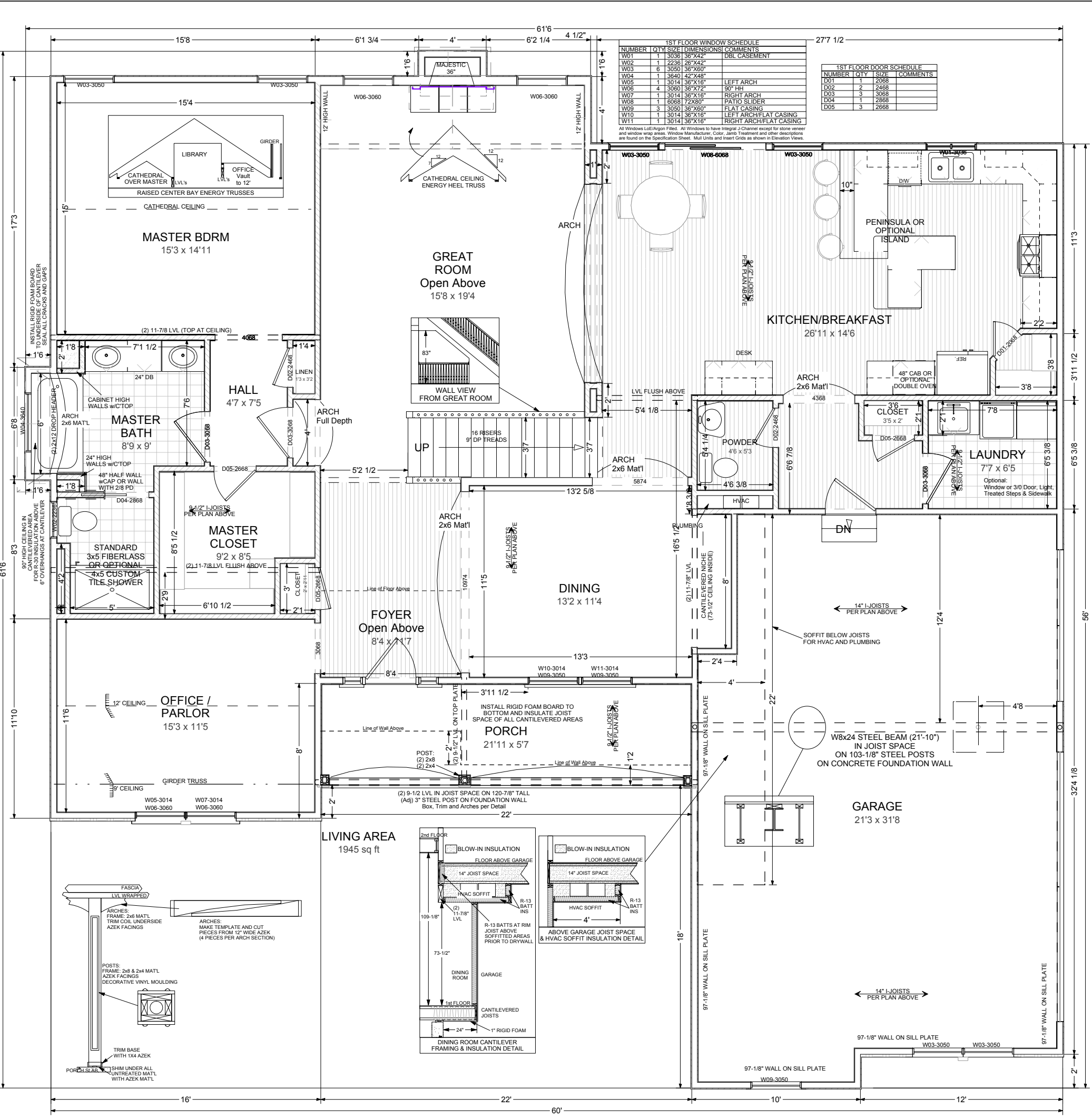

No Scale

Scale: 1/4 inch = 1 ft

